

door schedule

mark	size	type	hardware	closer	rating	notes
1.1	3'-0" x 7'-0"	existing storefront door	entry	-	-	no change
1.2	3'-0" x 7'-0"	existing storefront door	entry	-	-	no change
1.3	(2) 3'-0" x 7'-0"	existing storefront door	entry	-	-	no change
1.4						
1.5	3'-0" x 7'-0"	existing door	storeroom	●	60 minute	restore door and frame
1.6	3'-0" x 7'-0"	existing door	entry		60 minute	restore door and frame
1.7	3'-0" x 7'-0"	existing door	entry		60 minute	restore door and frame
1.8	3'-0" x 7'-0"	4 panel door	storeroom		-	solid mdf door

notes

- ① storefront under separate permit 2017P10742
- ② aluminum and glass entry door - under separate permit
- ③ sand and protect wood flooring with clear, matte finish
- ④ new replacement window unit: marvin ultimate clad unit
- ⑤ egress door is operable from egress side without a key, special knowledge, or effort (approved under separate permit 2017P10742)
- ⑥ existing tin ceiling over plaster and lathe to remain - repair as required
- ⑦ floor air supply register
- ⑧ side wall mounted air supply register
- ⑨ sound batt insulation in wall cavity. set wall framing in sound sealant
- ⑩ existing stairs to remain - repair treads, railing, and balusters if needed.
- ⑪ emergency egress lighting with battery backup

wall legend

MARK	WALL TYPE	DESCRIPTION
W-1		existing solid brick masonry bearing wall 8" thick min.
W-2		existing actual 2x4 studs at 16" oc with nominal 3/4" plaster finish on wood lathe
W-3		2x4 wood studs at 16" oc w/ 1 layer 5/8" type "x" fire rated gwb on each side w/ sound batt insulation.
W-4		2x4 wood studs at 16" oc w/ 2 layers 5/8" type "x" fire rated gwb on resilient channel on one side with 2-layers 5/8" type "c" fire rated gwb opposite side w/ perimeter caulked. w/ sound batt insulation.
W-5		interior non-bearing wall; (1) layer 1/2" g.w.b. ea. side of 2x4 wood studs @ 16"o.c.; sound batt insulation as noted on plans

EXISTING CEILING: pressed tin ceiling over plaster on 2x12 wood joists at 16" oc with 3/4" thick t&g subfloor.

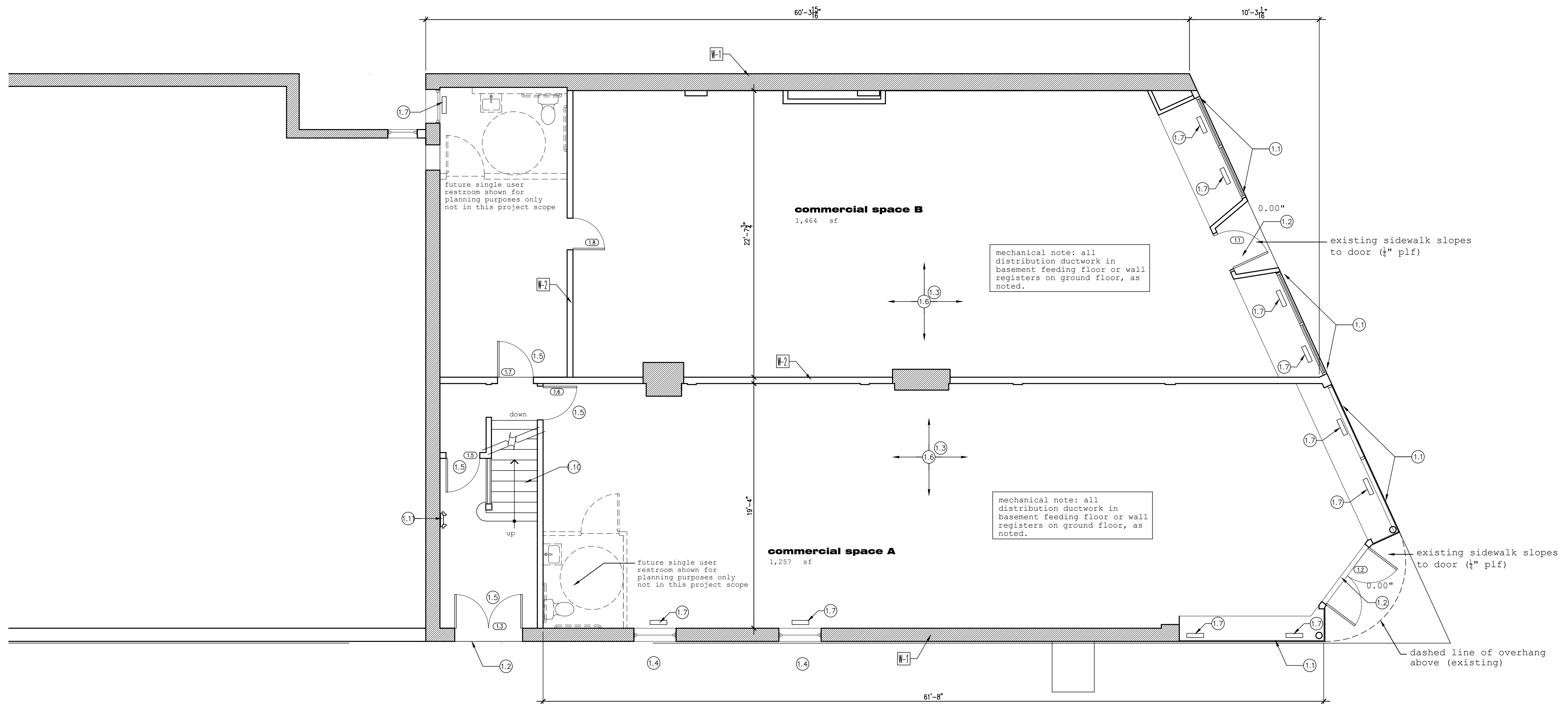

north

proposed ground floor plan
 scale: 1/4" = 1'-0"

ISSUE:
 FOR REVIEW 8.24.2017
 FOR REVIEW 11.6.2017
 FOR REVIEW 9.6.2018

PROJECT:
The Dow Building
5901 Hamilton Ave
Cincinnati, OH 45224

PROPOSED GROUND FLOOR PLAN

Eric C. Puryear
 ARCHITECT

VOX: 513.378.5058
 ecp@ericpuryeararchitect.com

ERIC C. PURYEAR
 OHIO LICENSE 1416098
 LICENSE RENEW: 12.31.2019

SHEET NO.

A2.1